

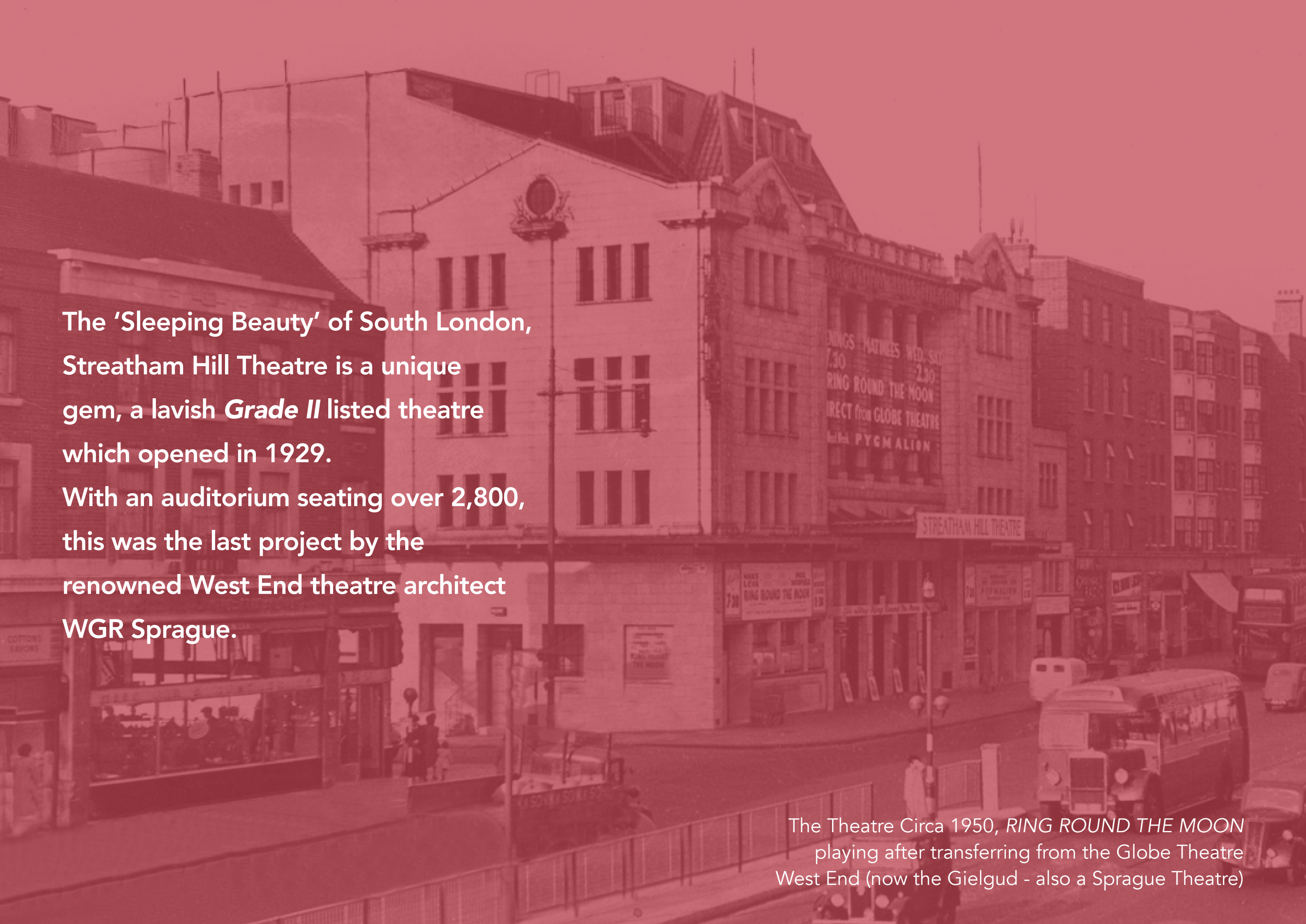

# STREATHAM HILL THEATRE

## CREATIVE VISION

Friends & Creative Industry Supporters



The 'Sleeping Beauty' of South London, Streatham Hill Theatre is a unique gem, a lavish *Grade II* listed theatre which opened in 1929.

With an auditorium seating over 2,800, this was the last project by the renowned West End theatre architect WGR Sprague.

The Theatre Circa 1950, *RING ROUND THE MOON* playing after transferring from the Globe Theatre West End (now the Gielgud - also a Sprague Theatre)



Having endured a direct V1 'doodlebug' hit during WWII, it reopened in 1950 and entertained visitors for another twelve years before being repurposed for bingo in 1962. Surviving to this day, it remains a unique example within a suburban setting where many theatres have been lost to the developer's wrecking ball.

Full House!  
The Bingo Years 1962-2017



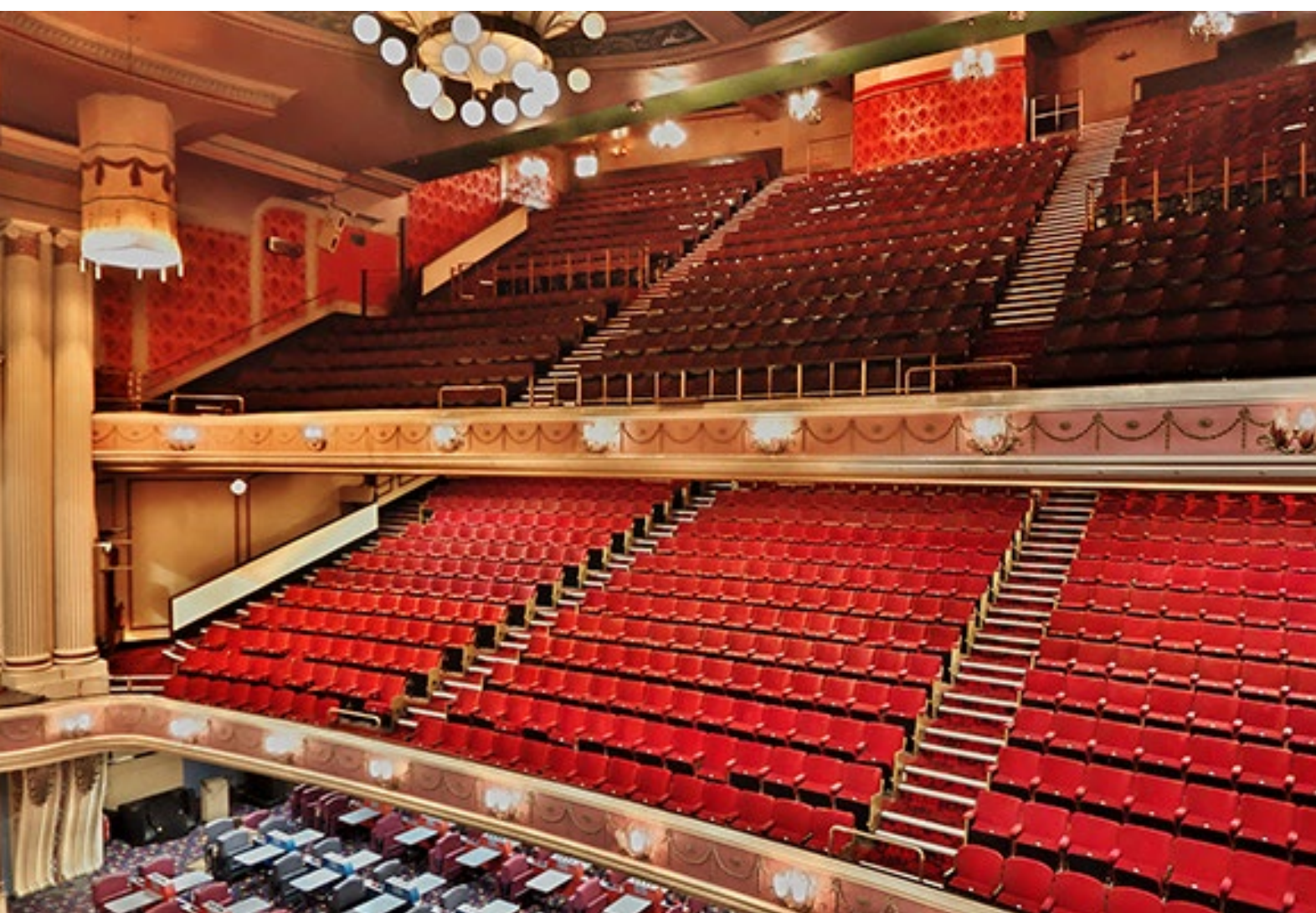

Images of the Theatre's exceptional internal state in 2018



With the closure of the bingo in 2017, the auditorium that hosted John Gielgud, Paul Robeson and Peggy Ashcroft now stands empty. Behind the stunning foyer a lounge currently accommodates rows of slot machines. The building was added to the Theatres Trust Theatres at Risk register in 2018. After a flashmob of over 1,000 people demonstrated huge local support, Lambeth Council approved the theatre as an ***Asset of Community Value*** in 2019.

Supporters Flash Mob  
20th November 2018

With the Theatre's future in jeopardy, the Friends launched a crowdfunding campaign in 2020.

Due to its success - and supported by grants from Mayor of London/GLA, Lambeth and the Theatres Trust - the Friends are now commissioning an economic assessment and viability study into the benefits of restoring the Theatre.

Simon Callow and Catherine Russell help to celebrate the Theatre's 90th Birthday.  
20th November 2019

**With your support,  
the Friends would like to see the  
building not only saved but  
repurposed as a resource for the  
local community and the wider  
creative workforce.**

**Here is our vision for  
the future of this amazing  
historic Theatre:**





LANUIT

STREATHAM HILL THEATRE

Lambeth - The Streatham Play -  
20th May - 12 June at Main Theatre

Streatham Youth Theatre  
7-9PM ALL WEEK @ GALLERY

- AS YOU LIKE IT -  
ON NOW AT MAIN THEATRE

Streatham Hill Comedy Club  
Every Saturday @ 8pm







## Open Up/ Community Hub

Situated within a densely populated south London suburb with easy access to public transport links, our aim is to restore the Theatre as a sustainable creative hub. This would be enjoyed by the diverse local community and visitors alike.

Improving the quality of the local streetscape, the vast front of house areas would be populated with independent retailers, cafes & bars allowing the Theatre to become a vibrant social destination.

Back of house areas would be rented as co-working and small office spaces to local businesses and community organisations. These commercial revenue streams would not only provide jobs, but help support the creative endeavours of the Theatre.

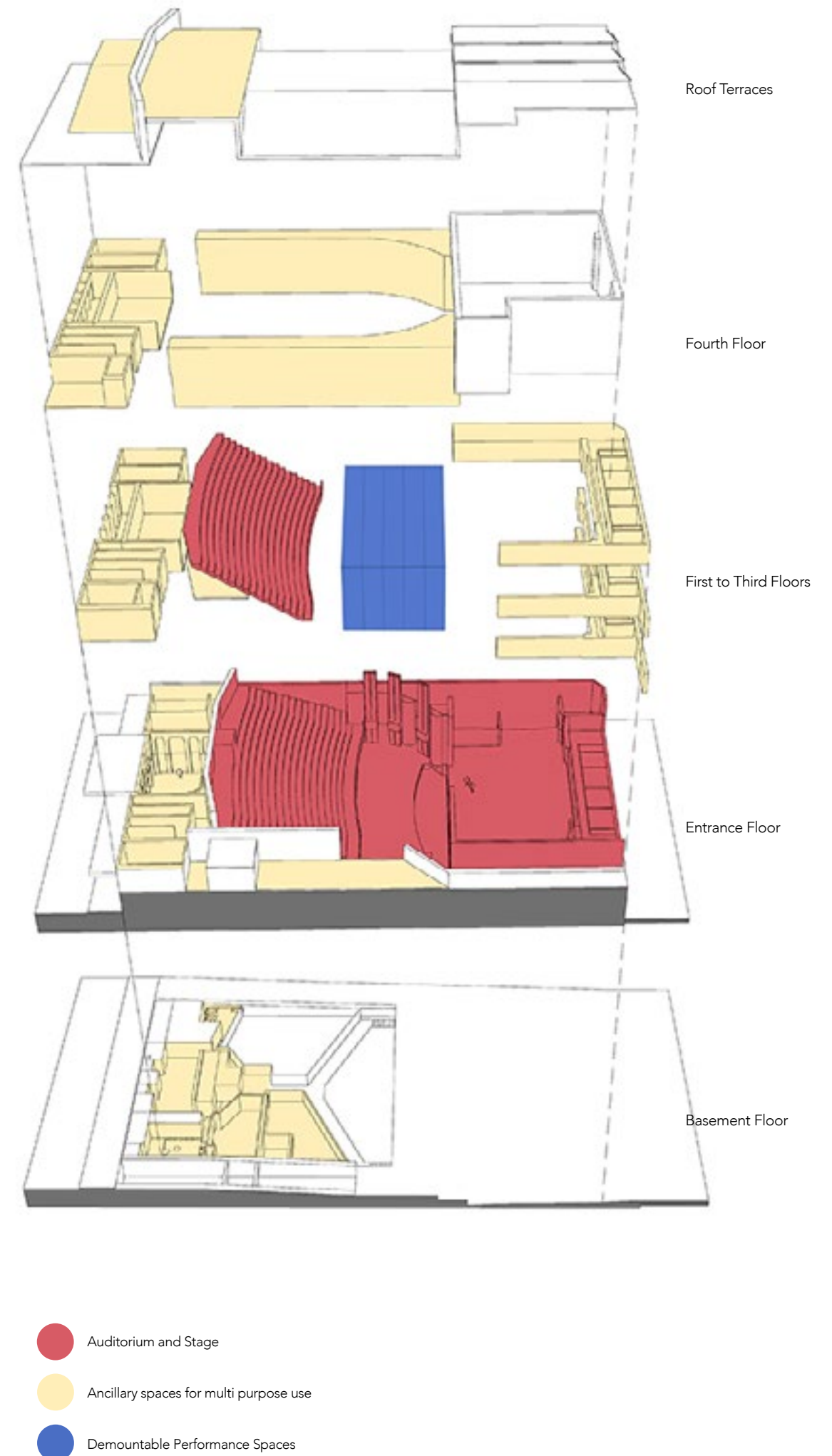



## Create / Participate:

The huge Grade II auditorium and stage will be preserved. By creatively reinventing the Theatre as a set of temporary and flexible sound proofed spaces, it would promote the inclusion and diversity of local community groups.

Concurrently, the Theatre would function as a resource for professional creative practitioners at national and international levels:

### For Local Arts Groups:

(Drama, Dance, Music, Choirs)

- Rehearsal Spaces, large or small within the stage house, auditorium or ancillary spaces

### For Community Partnership / Education Groups:

- Meeting Rooms
- Conference Spaces
- Office Space
- Private events & occasions with hospitality resources on site

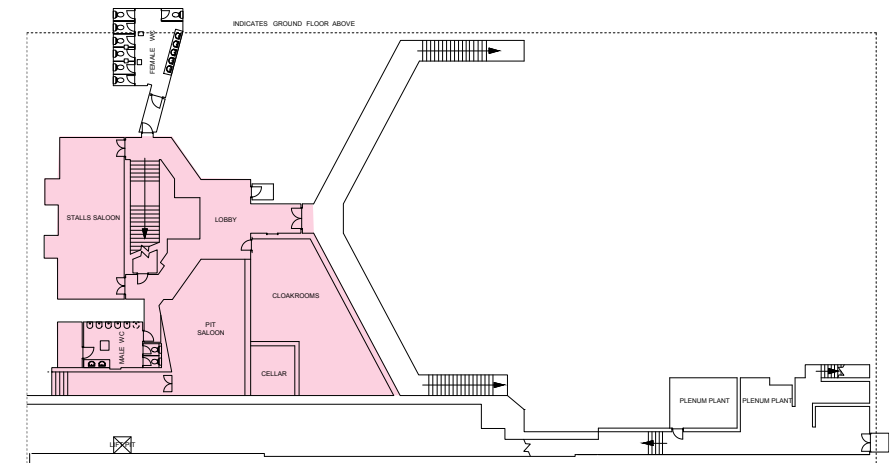

Basement

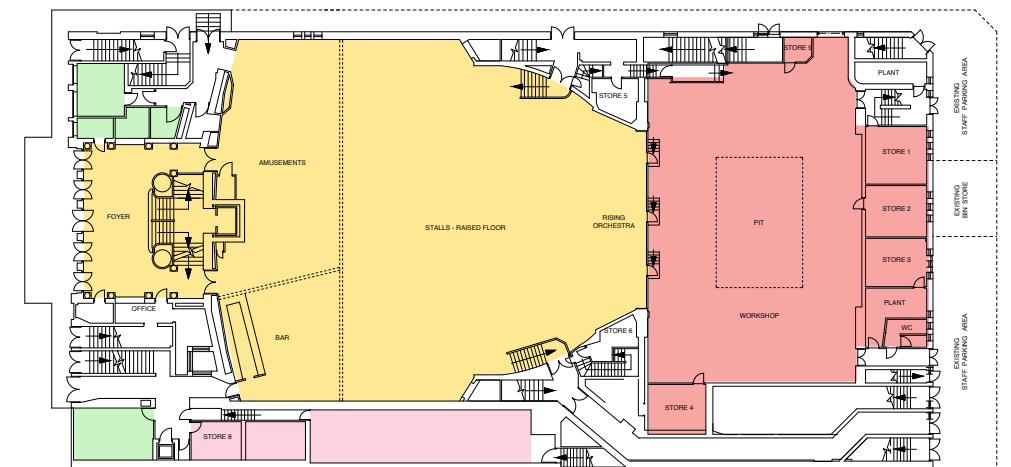

Ground Floor

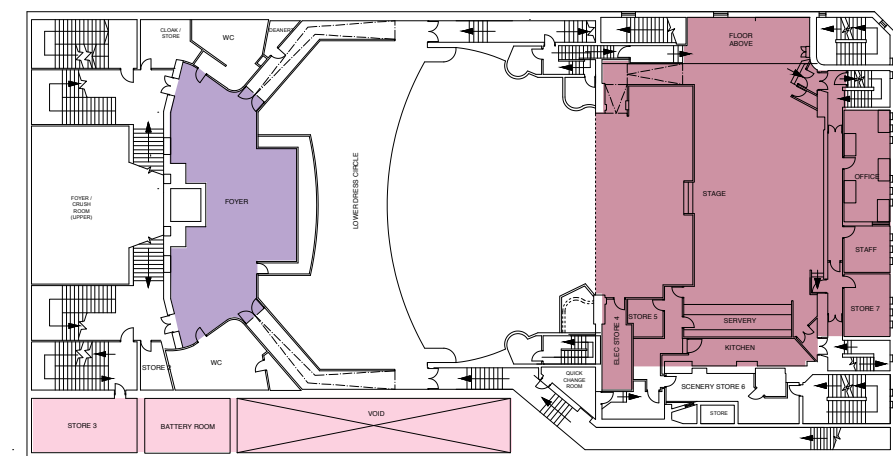

First Floor





## For Creative Practitioners: (Artists, Digital Creatives, Musicians)

- Creative Studios
- Co-working Spaces
- Recording Studios/ Production Suites

## For Television, Photography & Film Production:

- Theatre location shoots

## For Professional Production Companies: (Drama, Dance, Musicals, Opera)

- Small rehearsal spaces for auditions, workshops and readings
- Rehearsals within the large stage house with sets and flown elements
- Full production rehearsals using stage and auditorium prior to touring or heading into the West End
- Space for offices, wardrobe, workshops to support the rehearsal process

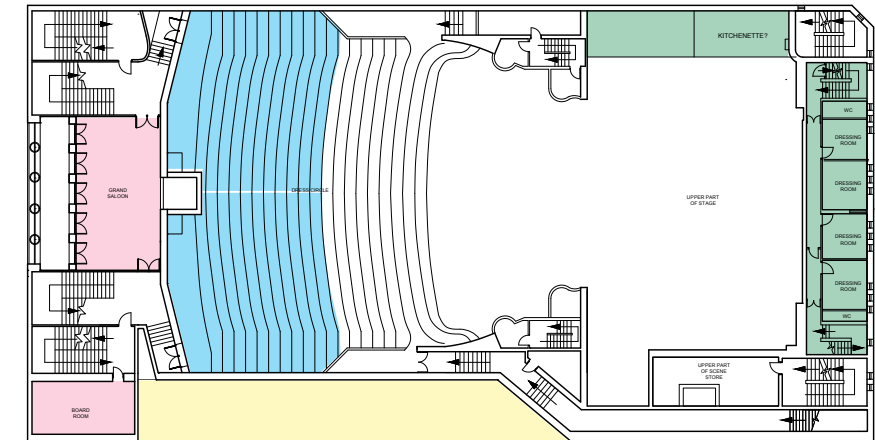

Second Floor

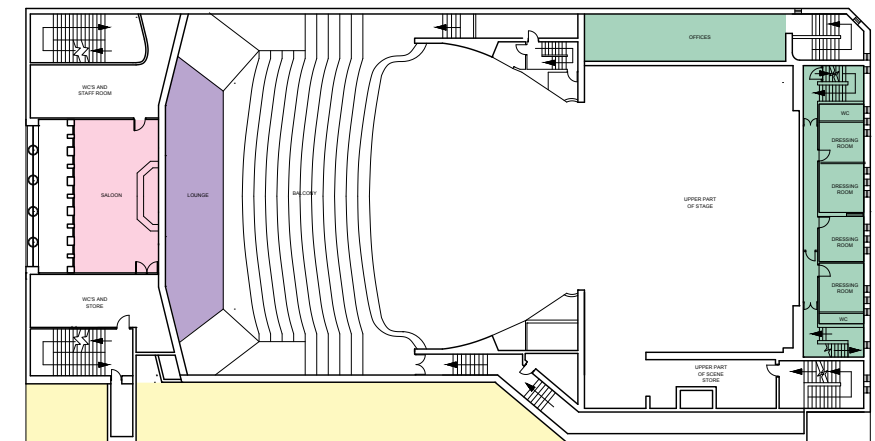

Third Floor

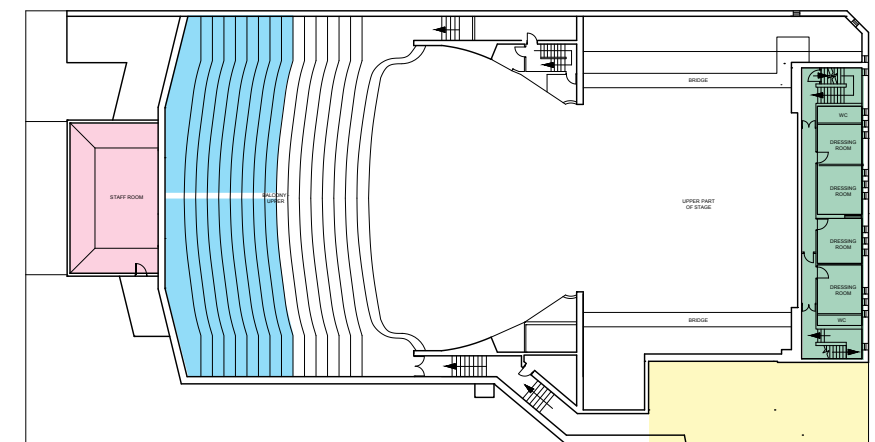

Fourth Floor

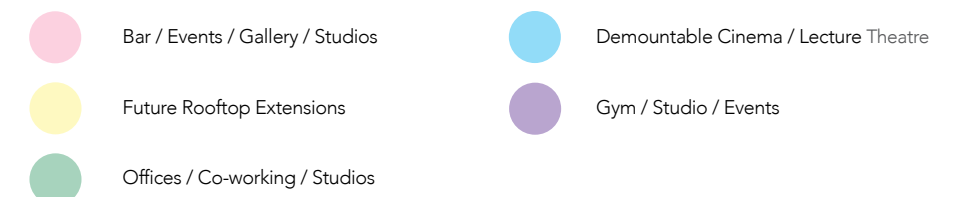



## Spectate:

Offering diverse and inclusive live performances across all genres is central to the aims of the Friends' vision.

Understanding that the huge auditorium poses a challenge, various flexible performance options would be available:

- Stage house as a large Studio Theatre, serviced by a substage temporary bar / foyer area
- Intimate demountable theatre module that sits within the auditorium
- Small Studio Theatre within the balcony undercroft
- Temporary spaces within the balconies for Films, Talks, Lectures
- Full auditorium & stage for capacity events like Pantomime, Comedy, Live Music

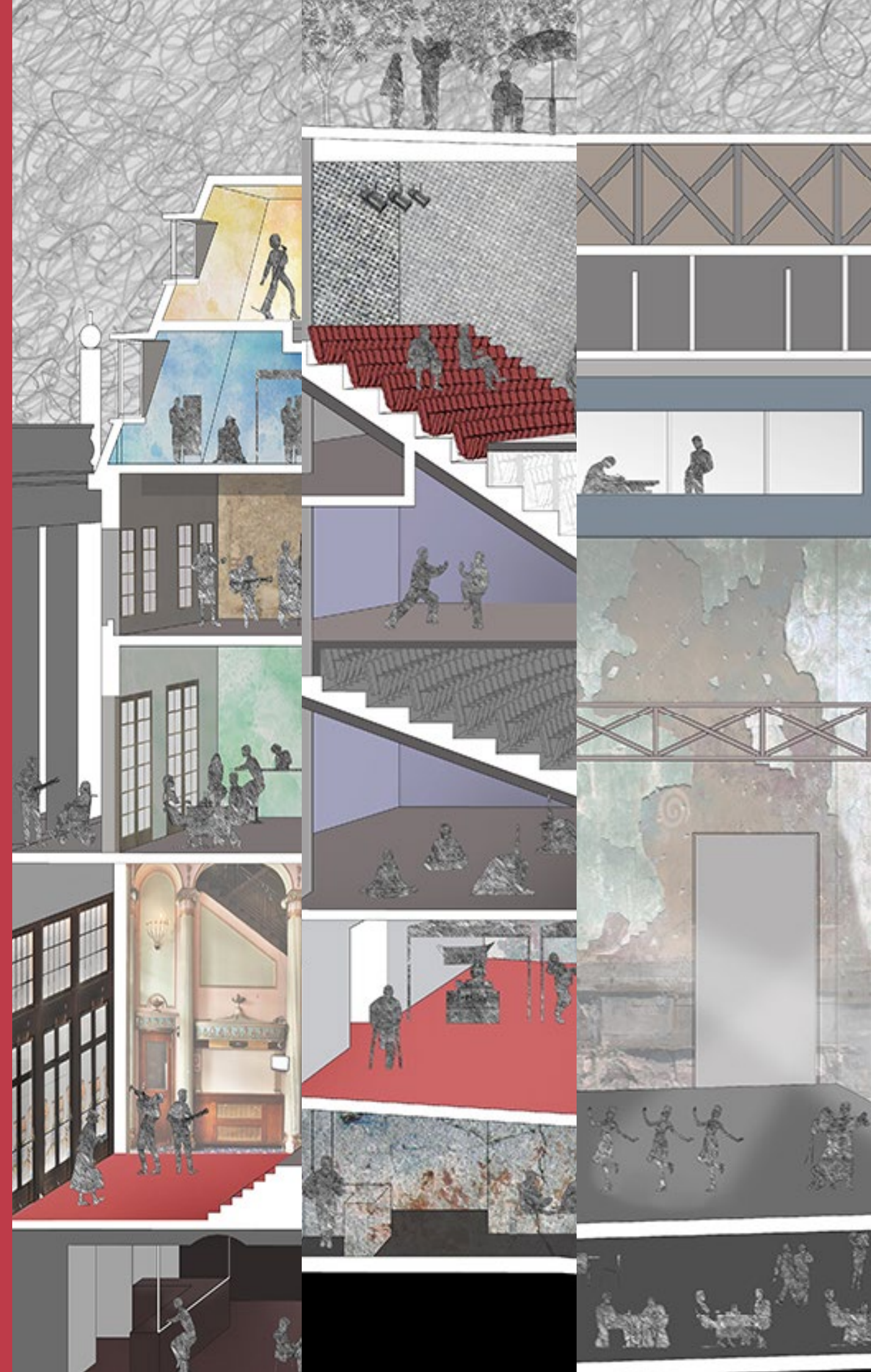



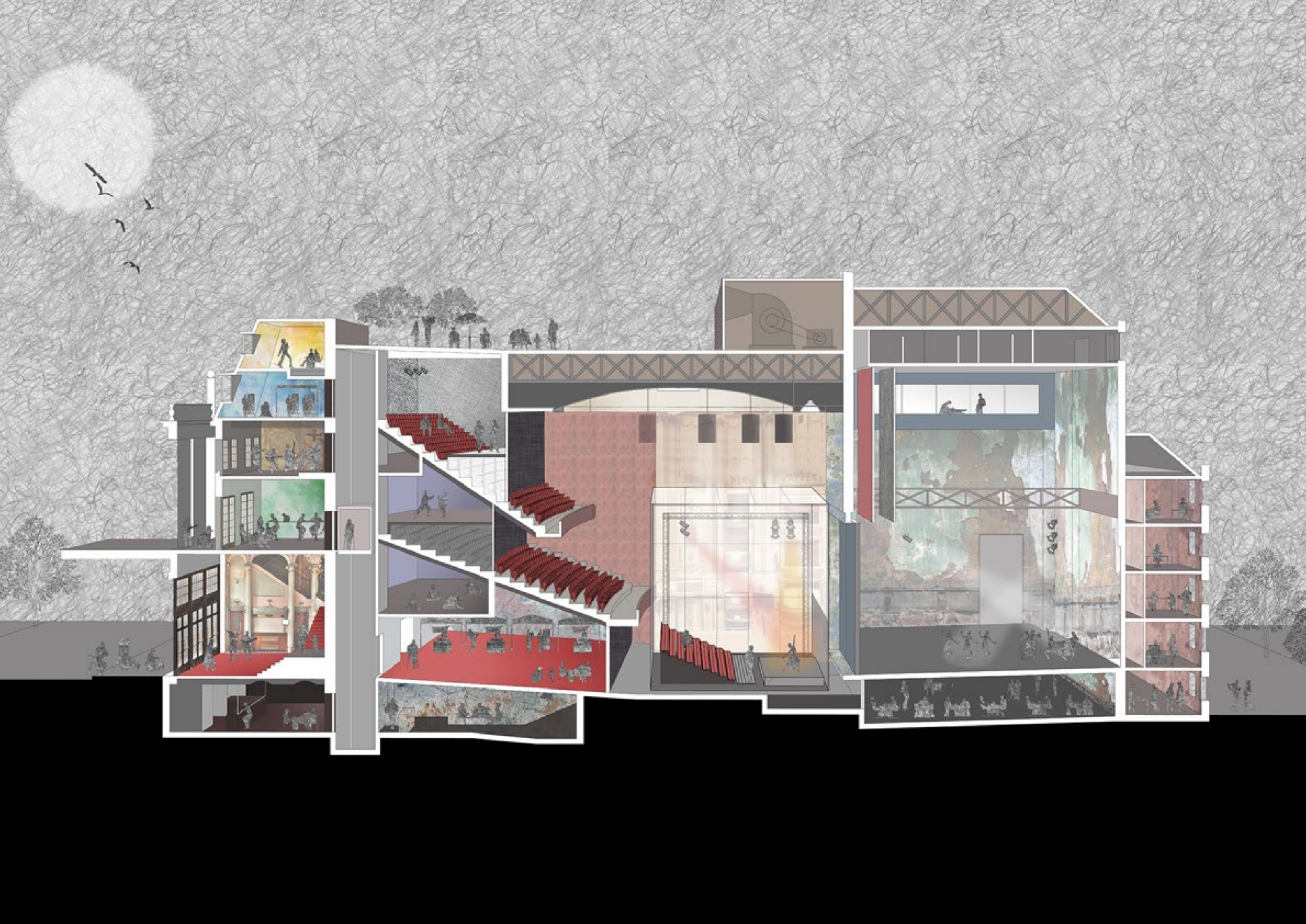



**With no public access to the Theatre,  
time is critical.**

**The Friends are now urgently  
working alongside stakeholders to  
protect it from neglect or  
redevelopment.**

**We need your support.**

**Please add your name to our  
Creative Industry Supporters List  
- before it's too late.**





**Thank you for your time**

**[www.streathamhilltheatre.org](http://www.streathamhilltheatre.org)**



Email us

**[supporters@streathamhilltheatre.org](mailto:supporters@streathamhilltheatre.org)**